

# VUE

ONE



325 Windermere Pl.



## Features:

- Four Bedrooms with Private Master Wing
- Four Bathrooms with “Spa” like Ensuite
- Gourmet Chef’s Kitchen with Quartz Counter Tops
- Two Storey Foyer and Vaulted Ceilings
- Media Room with built-in Bar and Exercise Area
- Custom built-in Office with Water View
- Terraced Decks offering Panoramic Ocean and City Views
- Private Patio with Arbour and Gas Fire Bowl
- Professional landscape design with custom Water Feature and Multi-Zone Sprinkler System

VUEBYABSTRACT.COM

 **Abstract**  
DEVELOPMENTS INC.  
National Award Winning - Custom Home Builder  
[www.abstractdevelopments.com](http://www.abstractdevelopments.com)



325 Windermere Pl.

ONE

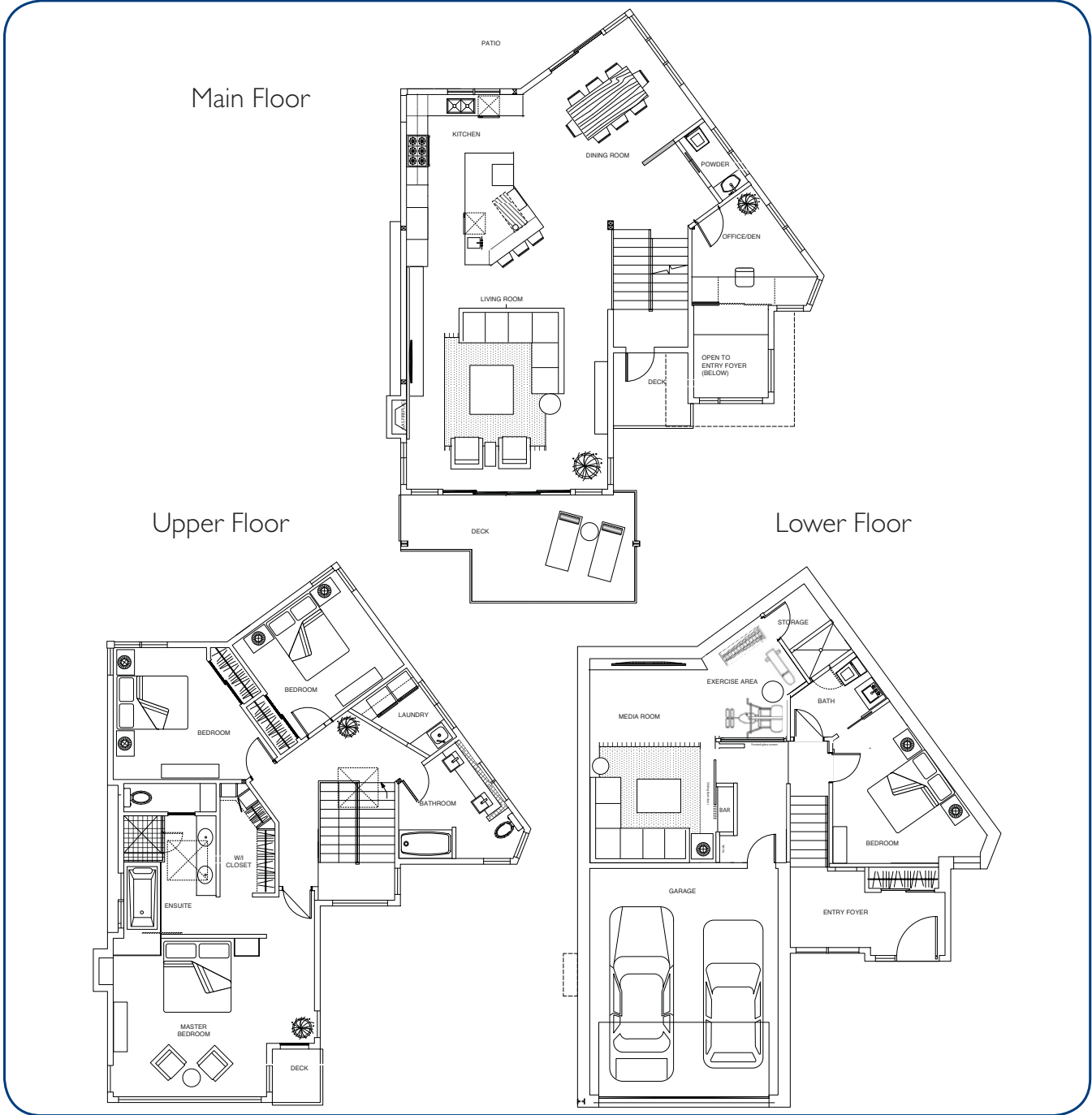

**Total Living Area ..... 3,396 sq ft**  
 Main ..... 1,230 sq ft  
 Upper ..... 1,228 sq ft  
 Lower ..... 938 sq ft  
 Garage ..... 445 sq ft  
 Decks ..... 619 sq ft

Abstract Developments Inc. reserves the right to make changes in order to improve the development. E&O



Mark Lawless Ph: 250.744.3301  
[www.marklawless.com](http://www.marklawless.com)